

MASTER PLAN NOTES

Hole 1 Oswego Country Club

Par 5

Yardage: 532 - 491 - 415 - 415

450

Hole 1 –

- A. Add “senior” tee at 450 yards
- B. Rebuild forward tee
- C. Establish Natural area on left as shown
- D. Add fairway bunkers on drive – (left short / long right)
- E. Expand fairway in areas as shown
- F. Regrade fairway / fix drainage & soften choppy areas
- G. Reposition left greenside bunker up fairway +/- 125 yards
- H. Reposition / Rebuild front right bunker

Green Area Plan

Scale: 1" = 50' (30' Grid)

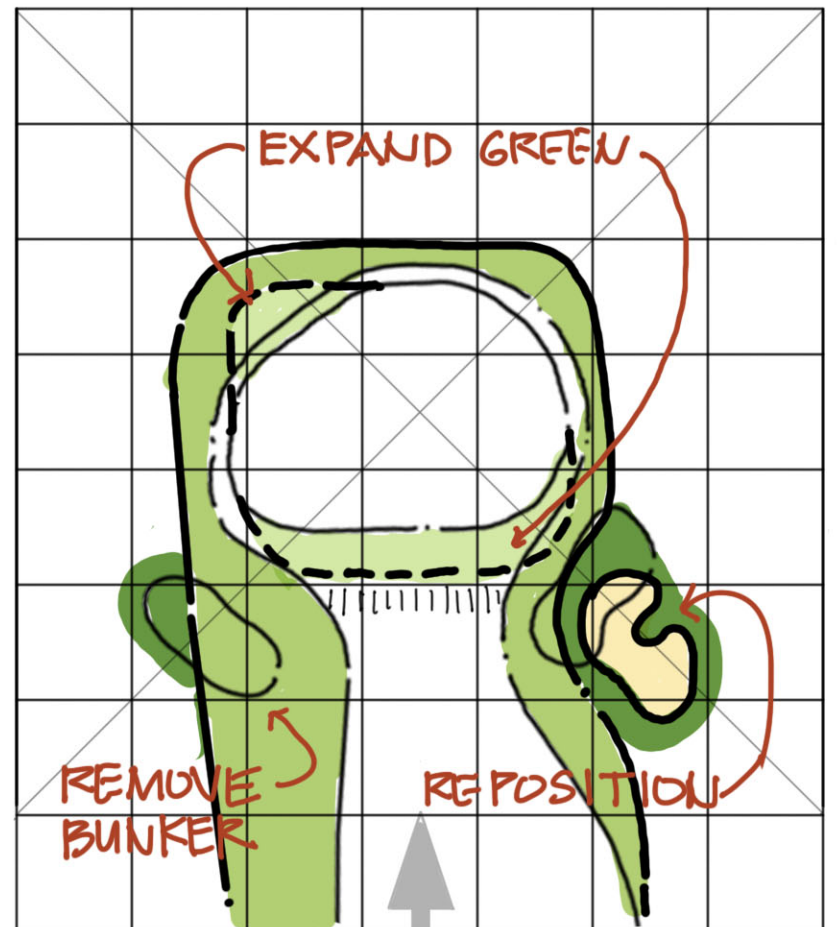

Centerline of Play

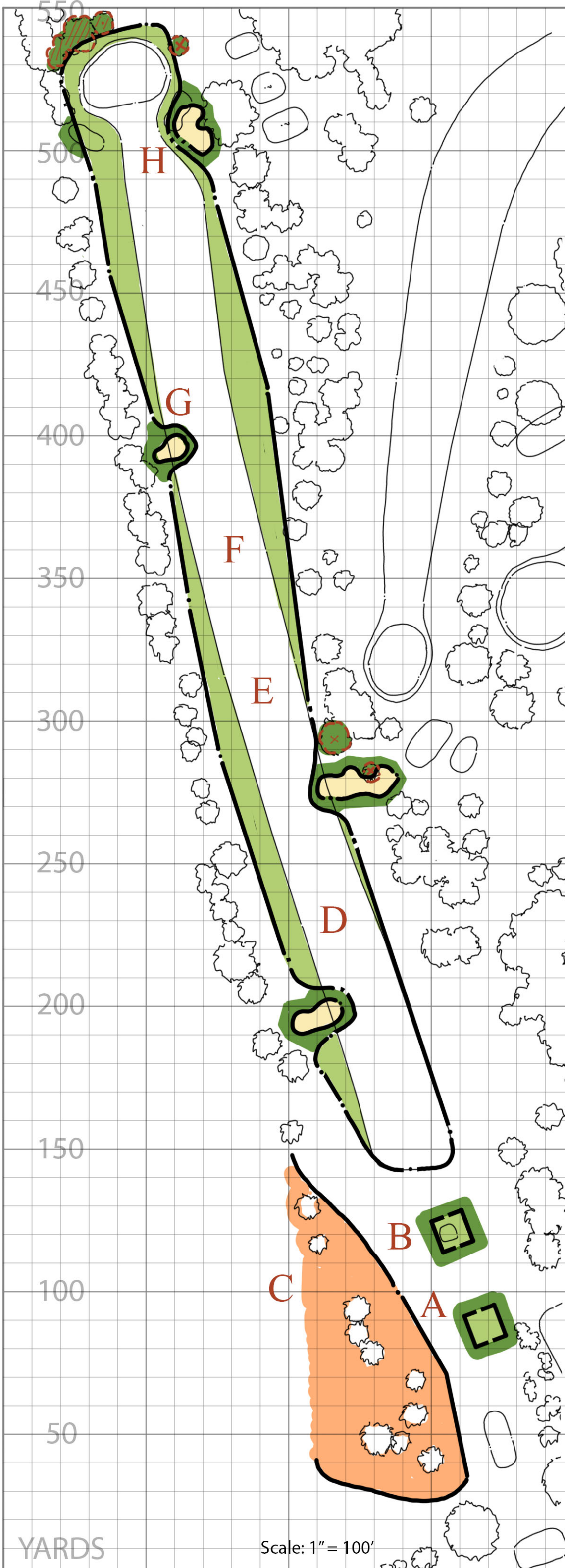

Scale: 1" = 100'

YARDS

MASTER PLAN NOTES

Hole 2 Oswego Country Club

Par 3

Yardage: 183 - 169 - 146 - 146

125

Hole 2 –

- A. Remove trees as shown
- B. Add forward tee at +/- 125 yards
- C. Prune trees around tee box
- D. Add seasonally mowed areas as shown
- E. Change fairway & approach mowing pattern
- F. Rebuild bunkers around green as shown (3) & make back left bunker a grass hollow
- G. Mow approach / collar into 3rd hole back tee
- H. Realign cart path
- I. Fix drainage

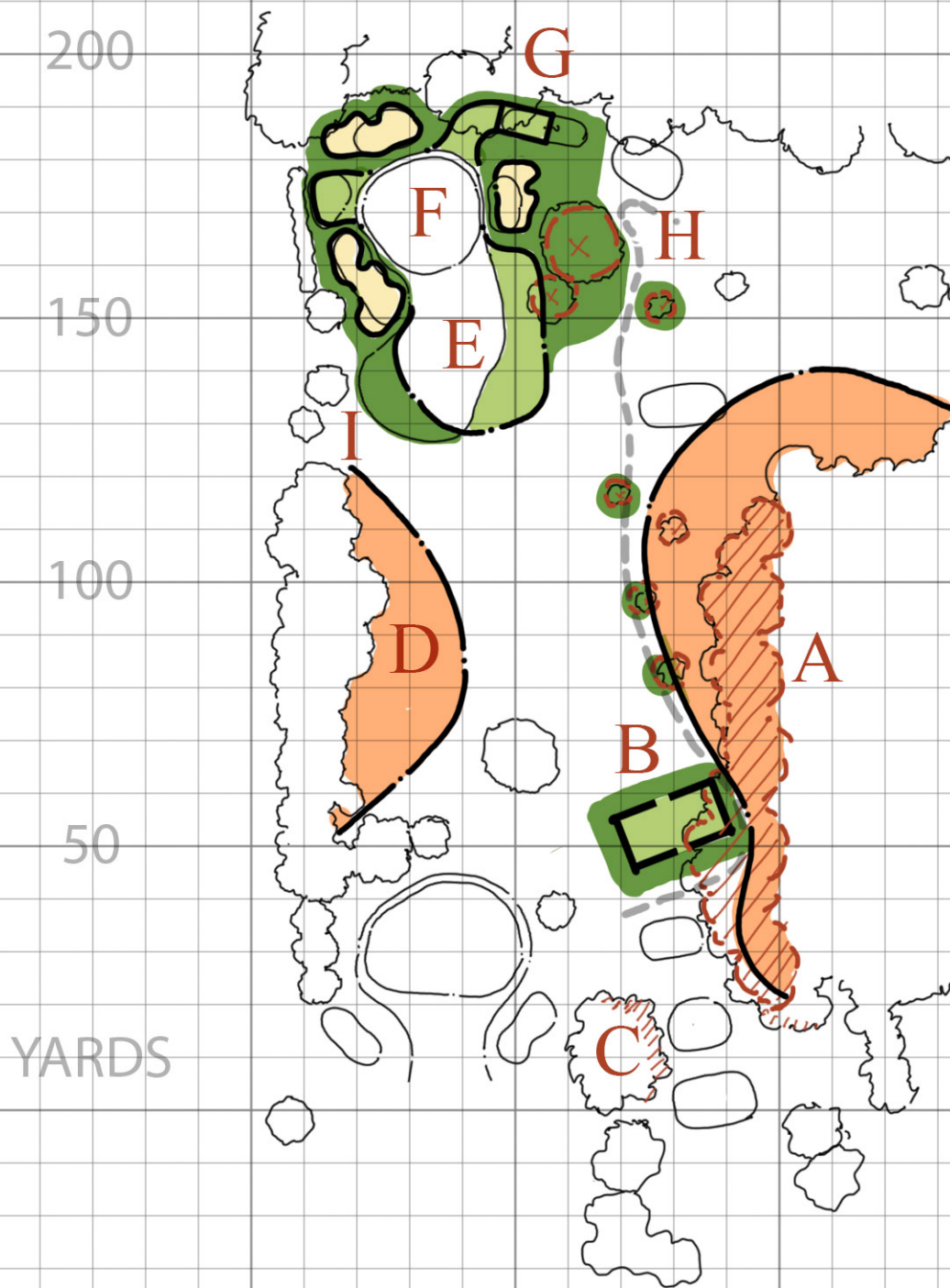

Green Area Plan

Scale: 1" = 50' (30' Grid)

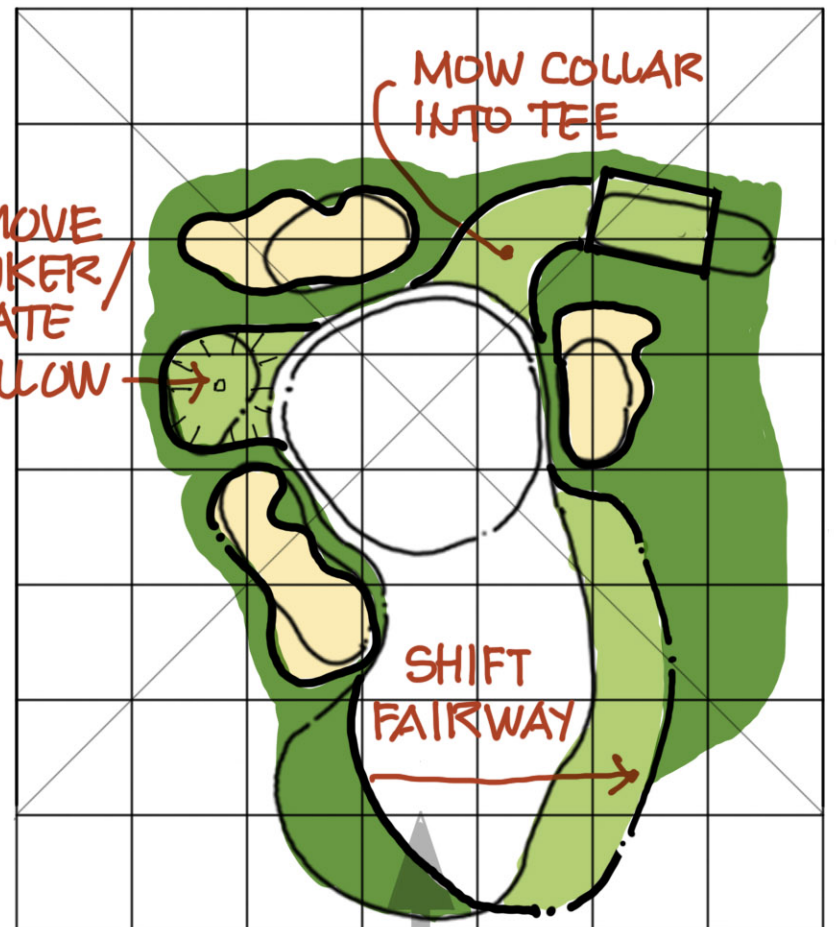

Centerline of Play

Scale: 1" = 100'

MASTER PLAN NOTES

Hole 3 Oswego Country Club

Par 4

Yardage: 347 - 333 - 322 - 322

262 232

Hole 3 –

- A. Regrade & reorient back tee boxes
- B. Add Senior & forward tees
- C. Abandon tee
- D. Plant / screen left side of fairway
- E. Add bunker left side of fairway +/- 285 yds
- F. Add 10 yards to right side of fairway as shown
- G. Remove trees & thin out understory in woods on right side as shown
- H. Expand green & surrounds
- I. Reshape existing right greenside bunker
- J. Add historic left greenside bunker

Green Area Plan

Scale: 1" = 50' (30' Grid)

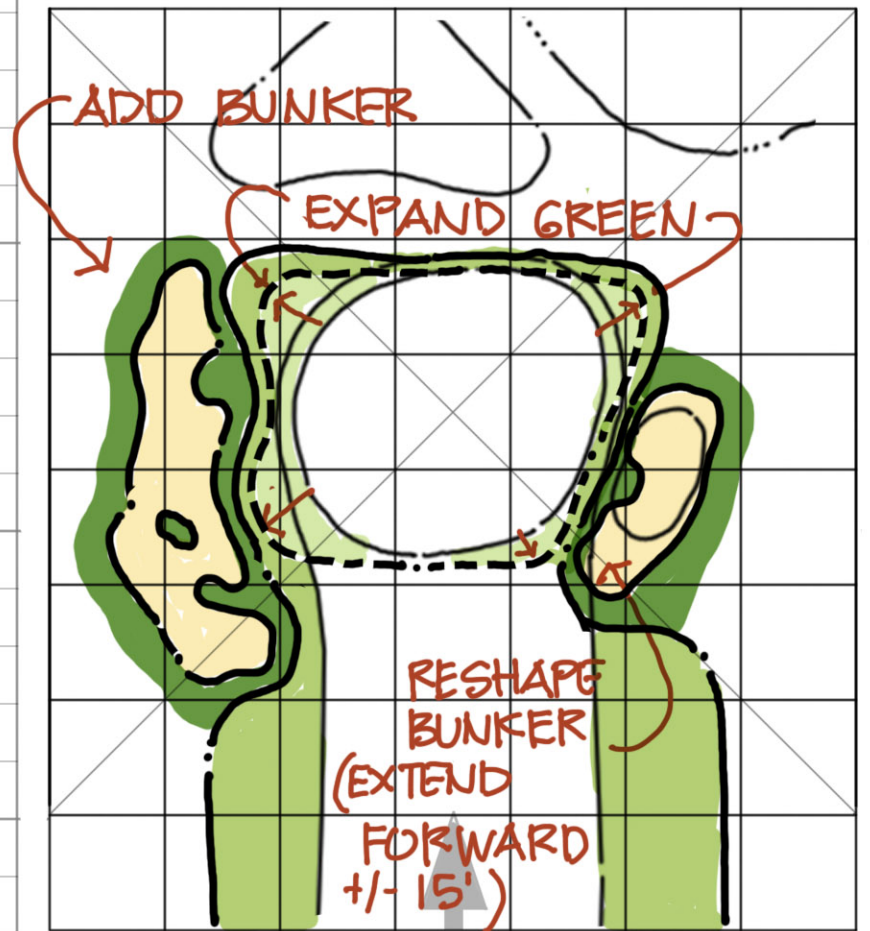

Centerline of Play

YARDS

Scale: 1" = 100'

MASTER PLAN NOTES

Hole 4 Oswego Country Club

Par 3

Yardage: 173 - 163 - 111 - 111

95

Hole 4 –

- A. Remove trees surrounding green complex
- B. Remove large trees left side of green
- C. Rebuild & expand left greenside bunker (lower bottom of bunker elevation +/- 3')
- D. Move cart path left, away from green (towards back of # 5 tee)
- E. Re-grade & create short grass chipping area left side of green as shown
- F. Re-grade / shape right side of green where trees removed
- G. Expand right side of green as shown

Green Area Plan

Scale: 1" = 50' (30' Grid)

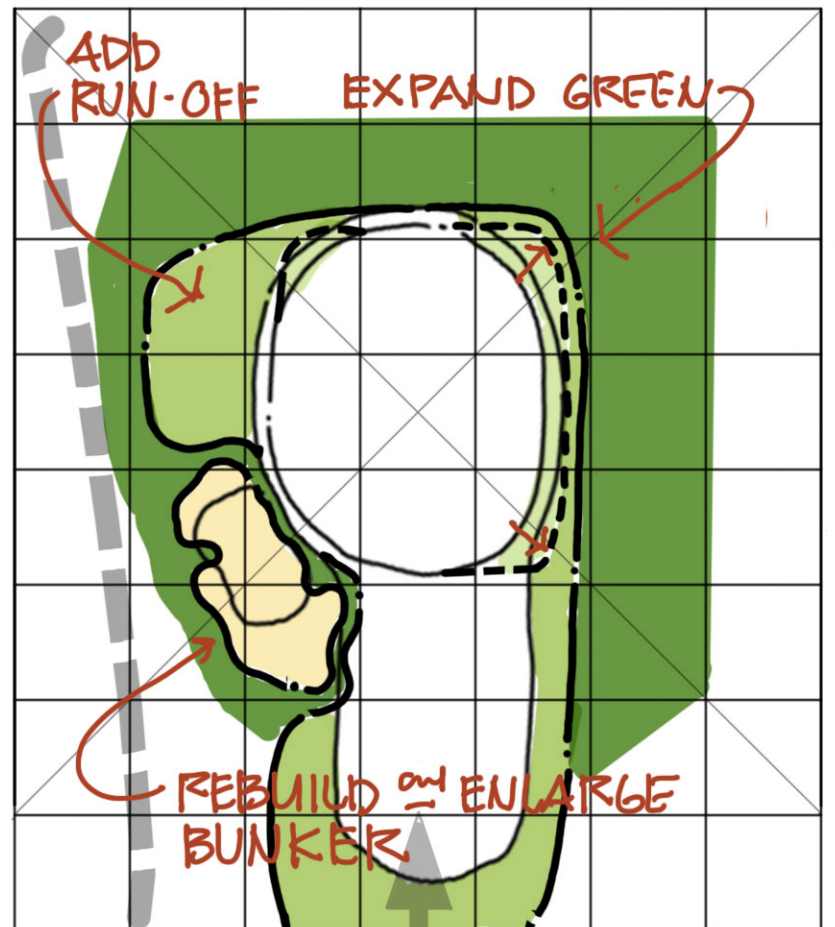

Centerline of Play

YARDS

Scale: 1" = 100'

MASTER PLAN NOTES

Hole 5 Oswego Country Club

Par 4

Yardage: 398 - 389 - 341 - 332

305

Hole 5 –

- A. Move Senior tee to corner of wall
- B. Add forward tee
- C. Shift fairway significantly left towards existing stone wall
- D. Remove trees as shown
- E. Add trees to right side of hole (after shifting fairway)
- F. Add bunker to right side of green
- G. Add fairway / short grass to left lower side of green

Green Area Plan

Scale: 1" = 50' (30' Grid)

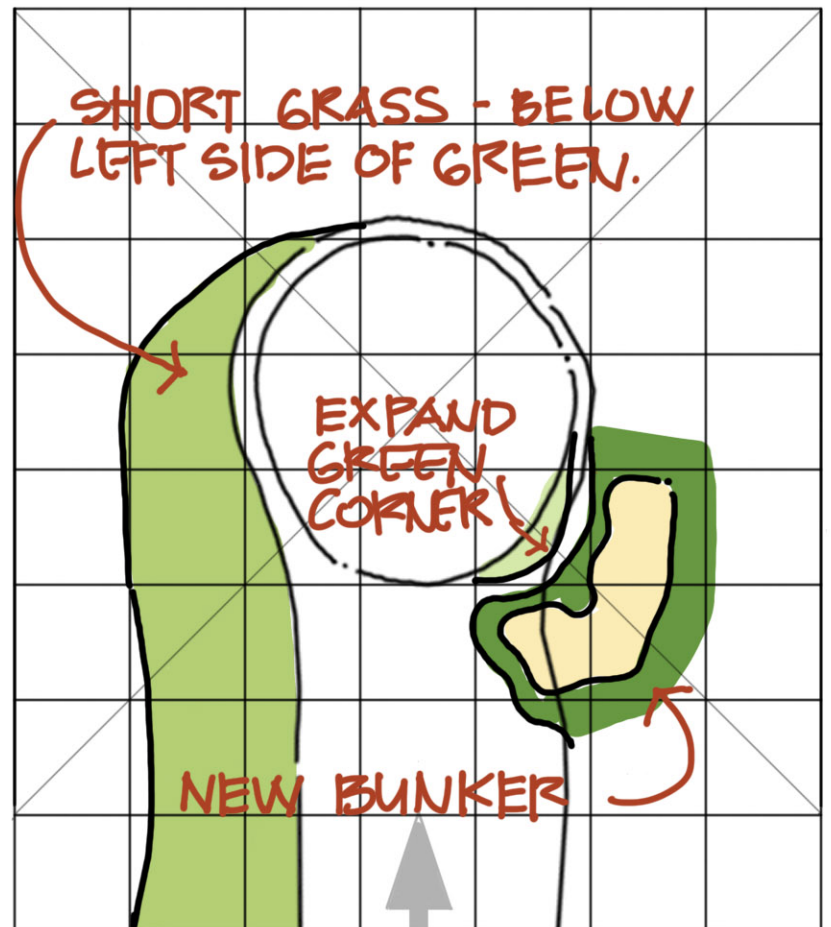

Centerline of Play

YARDS

50

100

150

200

250

300

350

400

450

500

G

F

E

C

D

B

A

MASTER PLAN NOTES

Hole 6 Oswego Country Club

Par 4

Yardage: 286 - 277 - 268 - 268

255 230

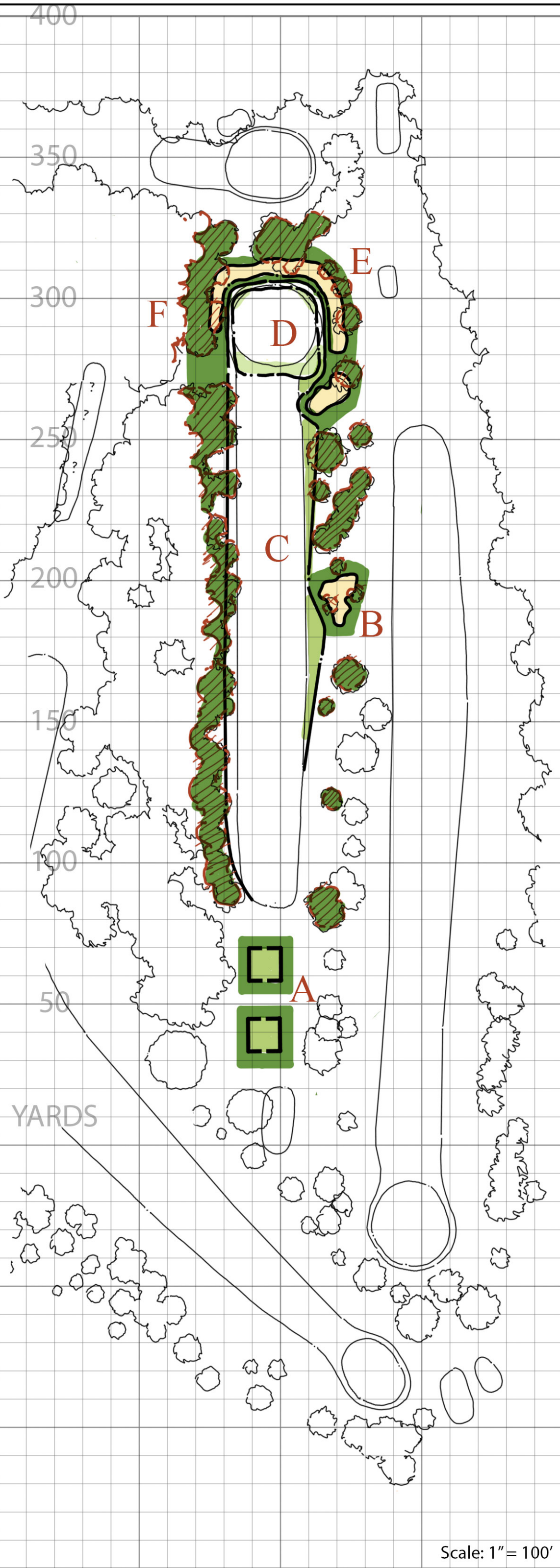

Hole 6 –

- A. Add senior and forward tees
- B. Restore old bunkers
- C. Remove trees – right & left side of fairways
- D. Expand green and surrounds as shown
- E. Reconstruct horseshoe bunker behind green
- F. Remove wood edge around left side of green

Green Area Plan

Scale: 1" = 50' (30' Grid)

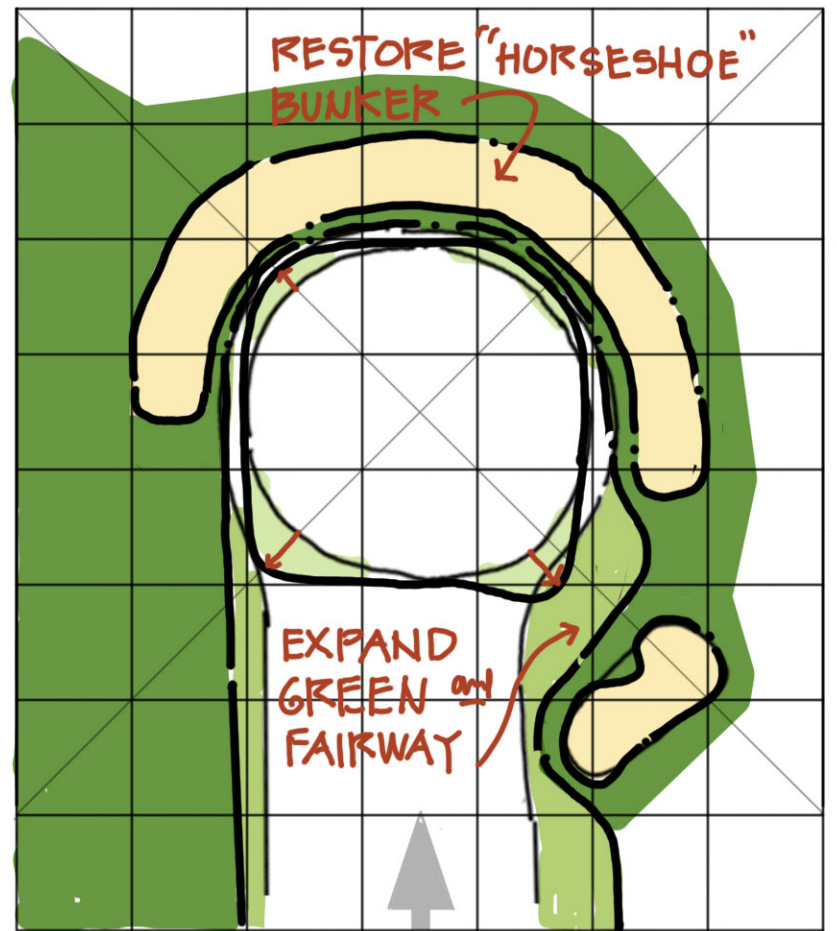

Centerline of Play

Scale: 1" = 100'

MASTER PLAN NOTES

Hole 7 Oswego Country Club

Par 4

Yardage: 422 - 406 - 379 - 379

410 360 335

Hole 7 –

- A. Rebuild tees into multiple boxes
- B. Remove trees as shown
- C. Expand fairway
- D. Expand green & widen approach

Green Area Plan

Scale: 1" = 50' (30' Grid)

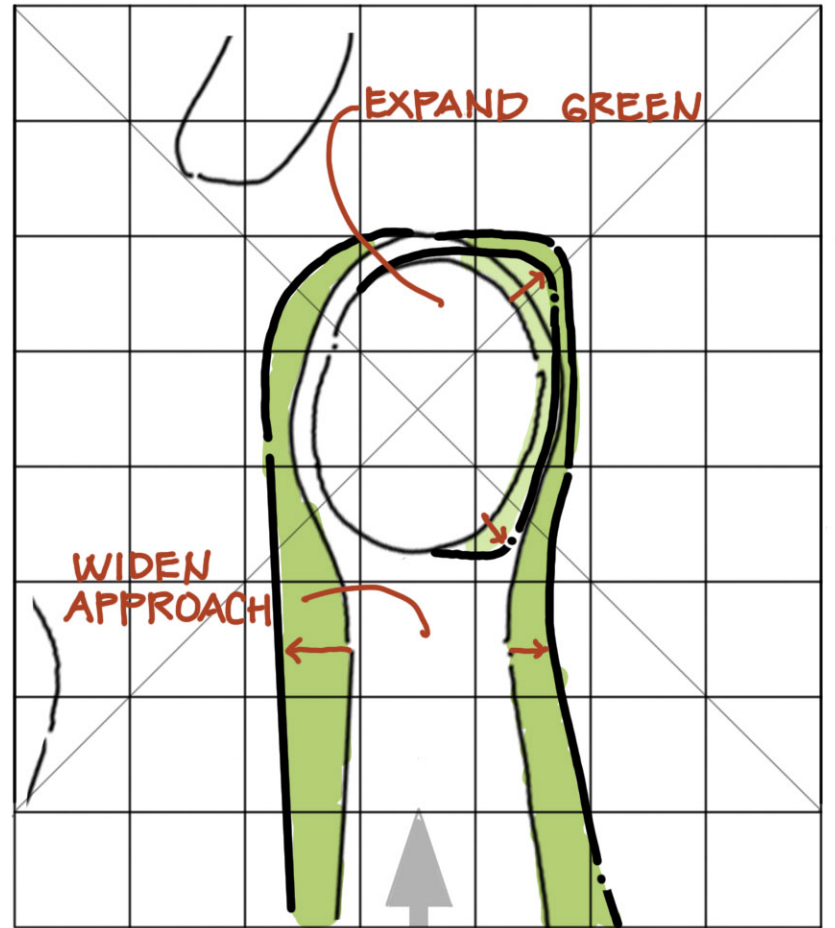

Centerline of Play



Scale: 1" = 100'

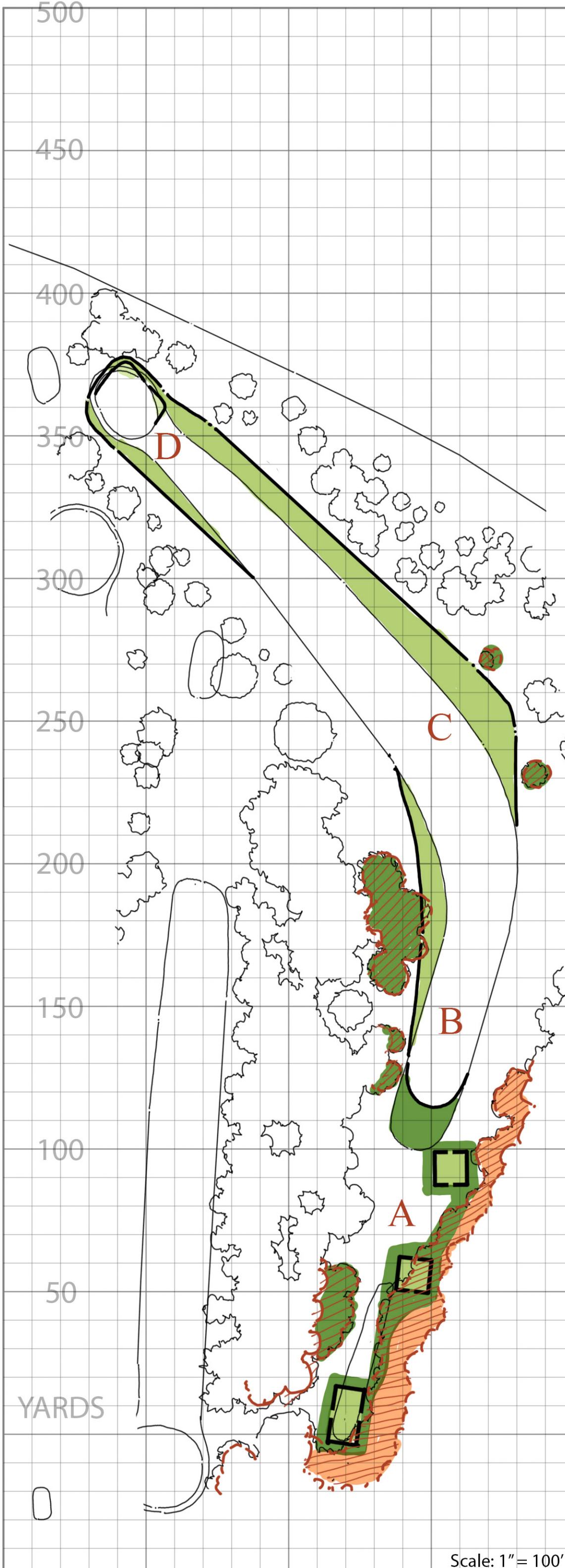

MASTER PLAN NOTES

Hole 8

Oswego Country Club

Par 4

Yardage: 417 - 408 - 357 - 339

500

450

400

350

300

250

200

150

100

50

YARDS

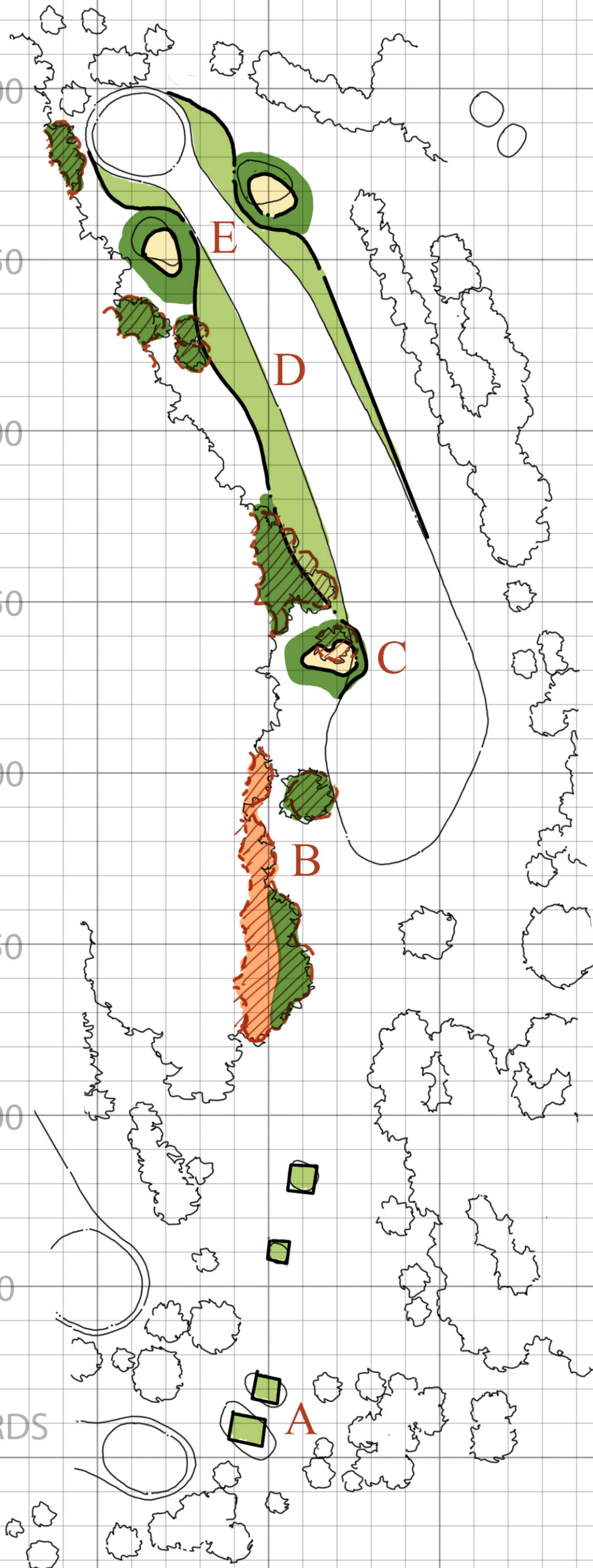

Scale: 1" = 100'

Hole 8 –

- A. Reorient tee mowing to line of play
- B. Remove trees as shown
- C. Add fairway bunker left side (+/- 250 yards out)
- D. Expand fairway as shown
- E. Rebuild / reshape 2 existing fairway bunkers - (Improve bunker visibility & ease of maintenance)

Green Area Plan

Scale: 1" = 50' (30' Grid)

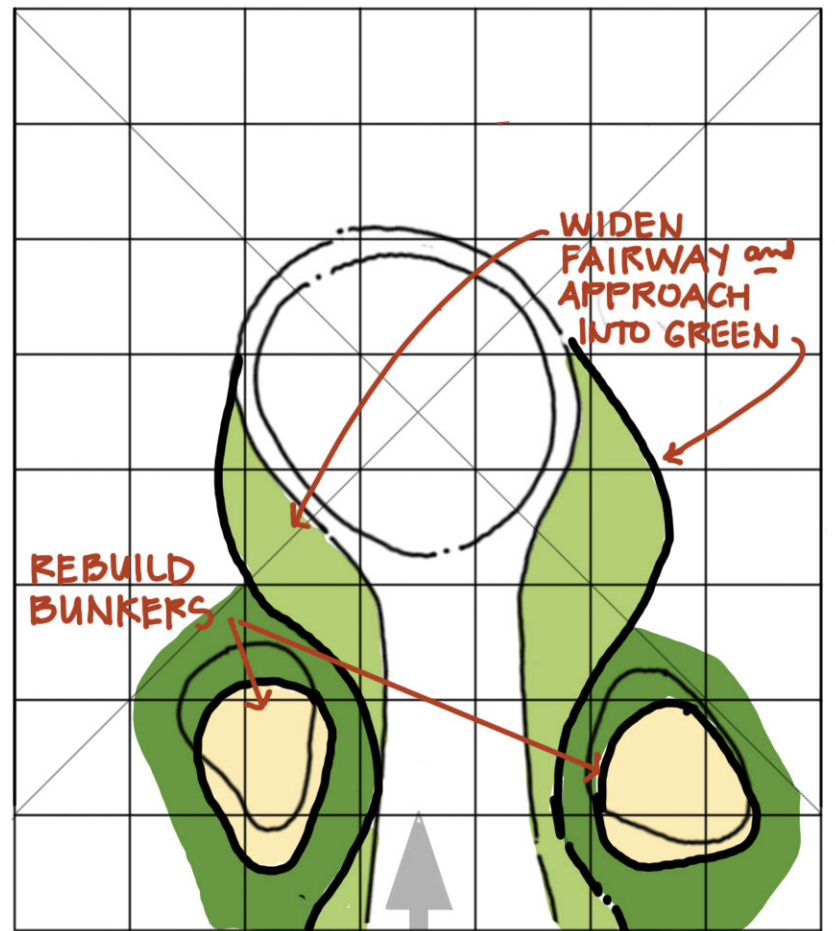

Centerline of Play

MASTER PLAN NOTES

Hole 9 Oswego Country Club

Par 4

Yardage: 375 - 357 - 307 - 287

390

Hole 9 –

- A. Add back tee
- B. Expand left side of fairway as shown
- C. Remove trees as shown
- D. Rebuild green complex

Green Area Plan

Scale: 1" = 50' (30' Grid)

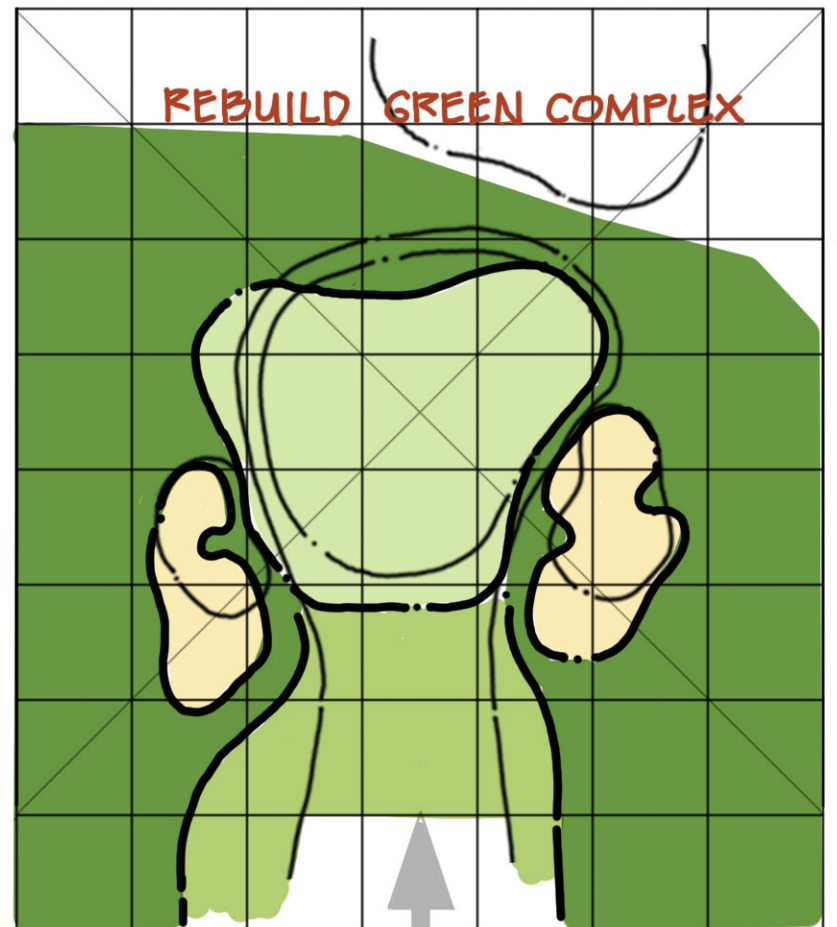

Centerline of Play

YARDS

50

100

150

200

250

300

350

400

450

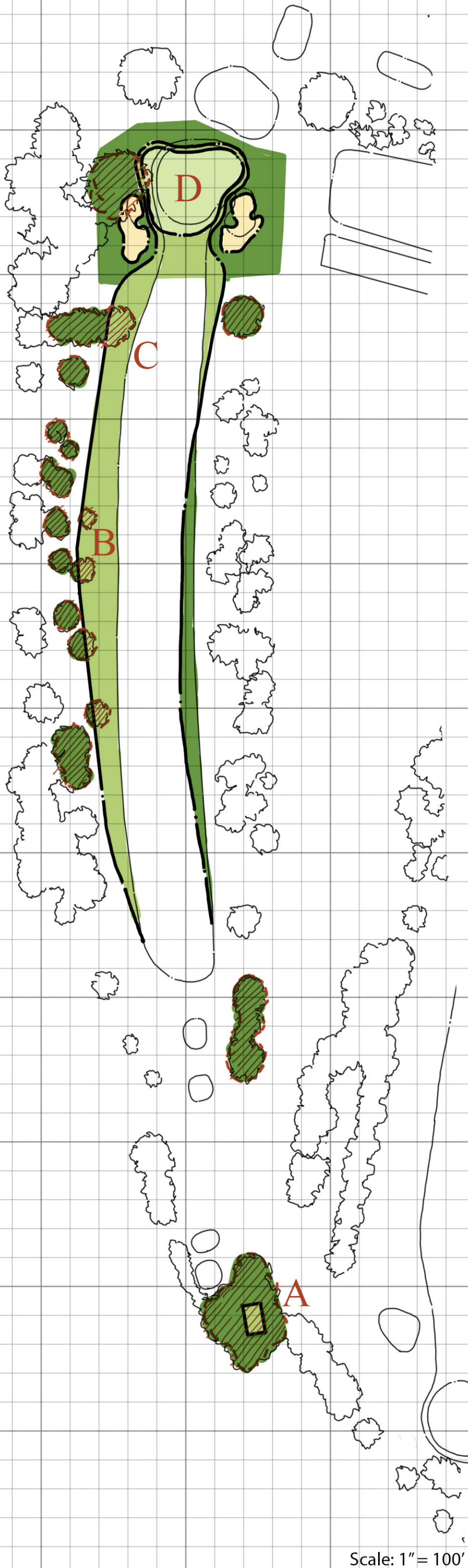

MASTER PLAN NOTES

Hole 10 Oswego Country Club

Par 5

Yardage: 543 - 520 - 441 - 441

395

Hole 10 –

- A. New forward tee
- B. Remove bunker
- C. Expand fairways as shown (allow ball to settle into flatter areas on right side of hole)
- D. Start fairway further up hole at bottom of ridgeline
- E. Plant trees in gap on right side
- F. Remove trees in areas shown
- G. Create run-off areas on right & back left of green
- H. Expand green on front right
- I. Seasonally mowed natural area patch
- J. Rebuild & reshape greenside bunkers (Shift front bunker 15' to left and turn bunker square to line of play; shape back bunker wider and into landform)

Green Area Plan

Scale: 1" = 50' (30' Grid)

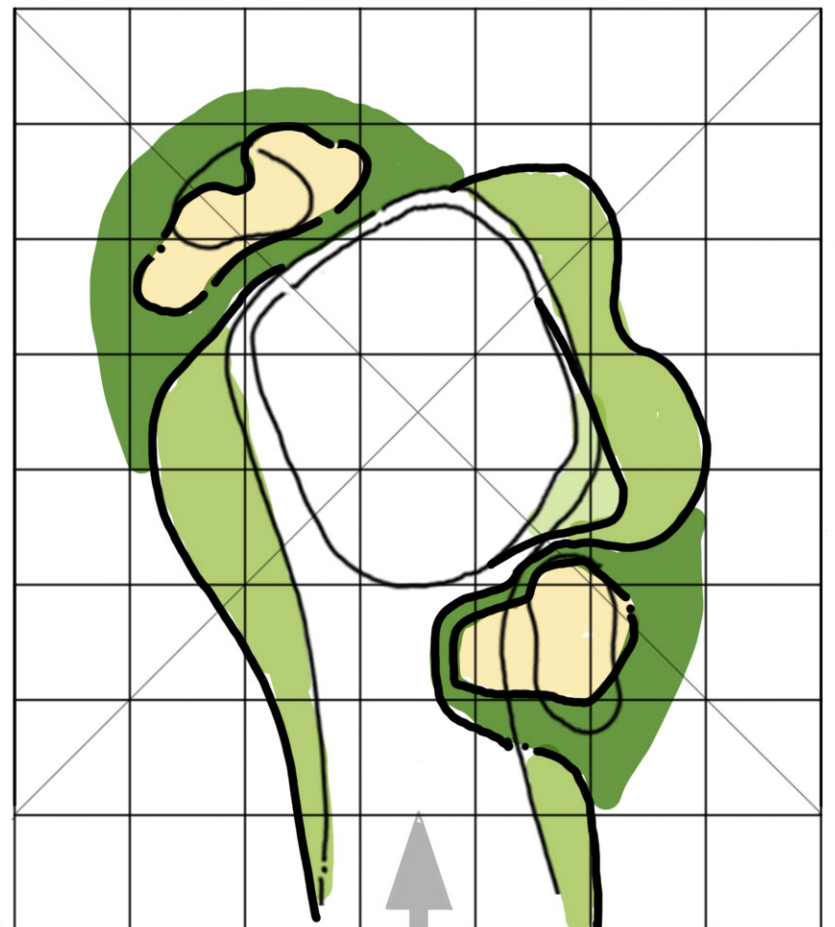

Centerline of Play

YARDS

Scale: 1" = 100'

MASTER PLAN NOTES

Hole 11 Oswego Country Club

Par 4

Yardage: 446 - 390 - 369 - 369

395 385 305

Hole 11 –

- A. Reshape existing tee / make one level
- B. Build forward tee
- C. Remove trees as shown
- D. Add fairway bunkers
- E. Expand fairway as shown (left side)
- F. Expand pond – make more visible
- G. Remove 2 trees behind green
- H. Rebuild greenside bunker
- I. Cut fairway / approach closer to the pond

Green Area Plan

Scale: 1" = 50' (30' Grid)

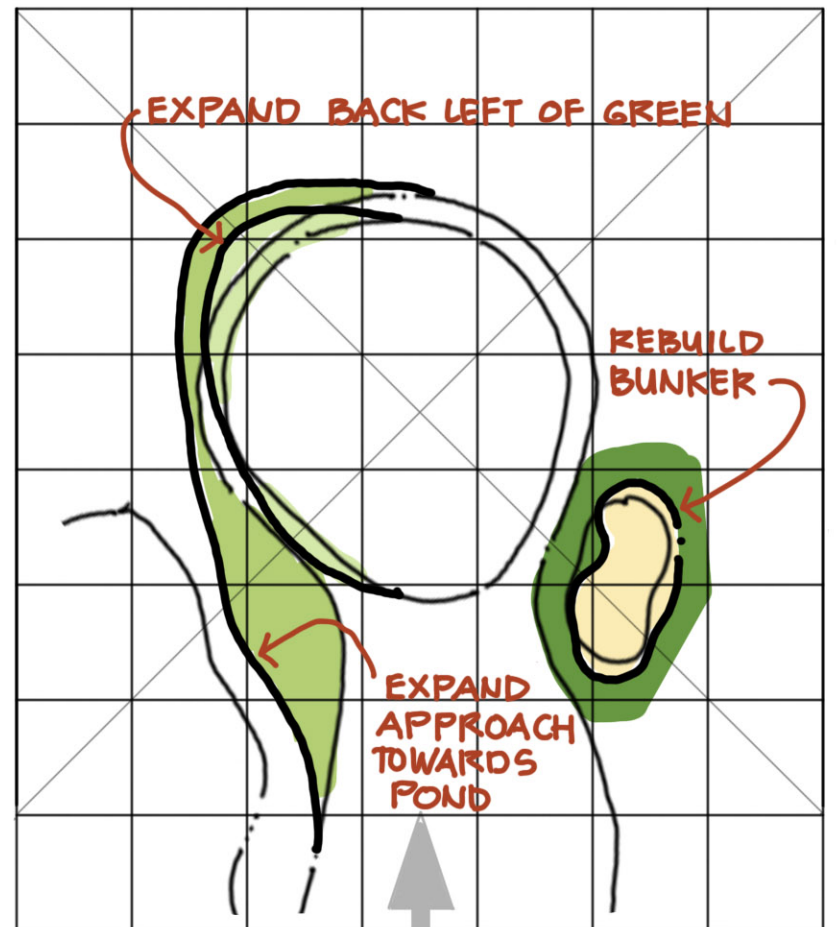

Centerline of Play

YARDS

Scale: 1" = 100'

MASTER PLAN NOTES

Hole 12 Oswego Country Club

Par 3

Yardage: 198 - 144 - 129 - 129

170 150 115

Hole 12 –

- A. Break front tee into 3 separate “lower tees”
(tee currently blocks view of green from back tee)
- B. Reshape fairway lines as shown
- C. Rebuild 2 right greenside bunkers into one
- D. Add runoff area on right side of green
- E. Remove trees as shown

Green Area Plan

Scale: 1" = 50' (30' Grid)

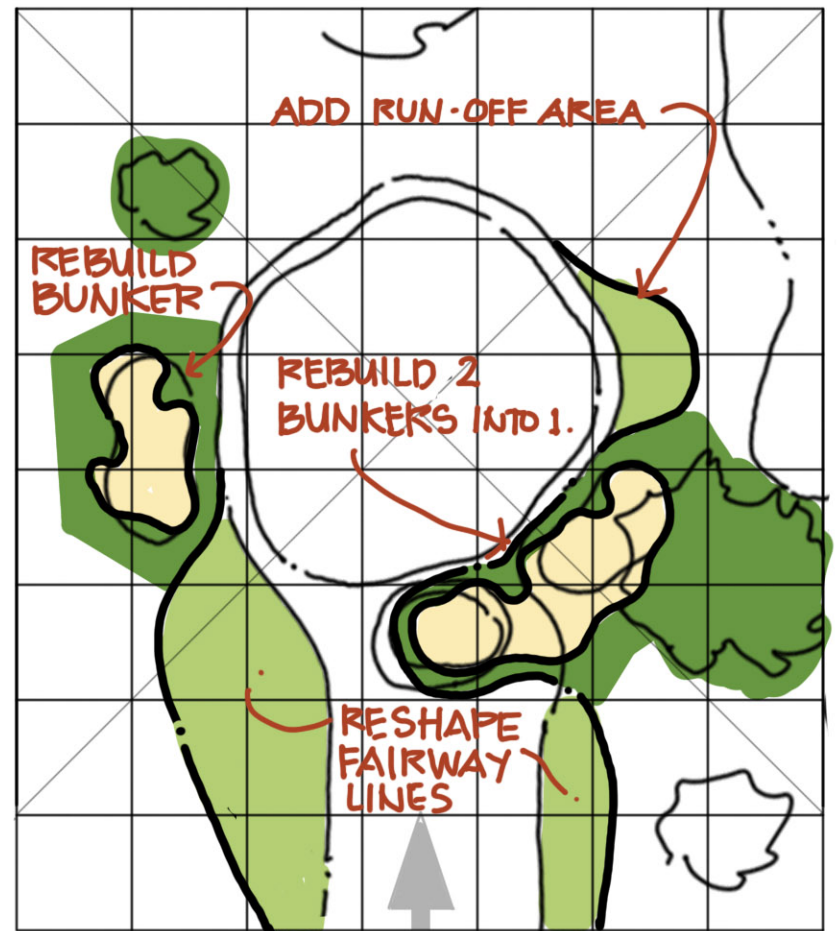

Centerline of Play

YARDS

Scale: 1" = 100'

MASTER PLAN NOTES

Hole 13 Oswego Country Club

Par 4

Yardage: 366 - 350 - 332 - 332

280

Hole 13 –

- A. New forward tee
- B. Fix drainage @ 150 – 200 yds
- C. Remove trees left side of hole as shown
- D. Expand fairway to the left side of hole
- E. Add bunker / pinch fairway at +/- 280 yds
- F. Expand pond
- G. Add stone wall at edge of pond near green
- H. Rebuild greenside bunker
- I. Remove trees behind green

Green Area Plan

Scale: 1" = 50' (30' Grid)

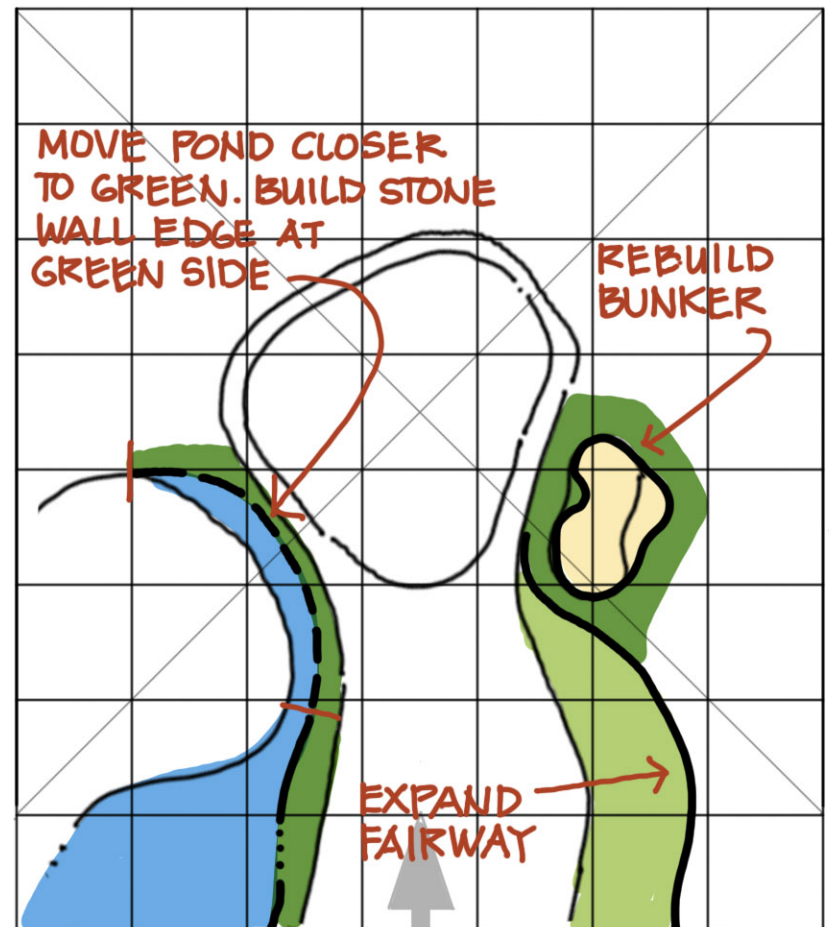

Centerline of Play

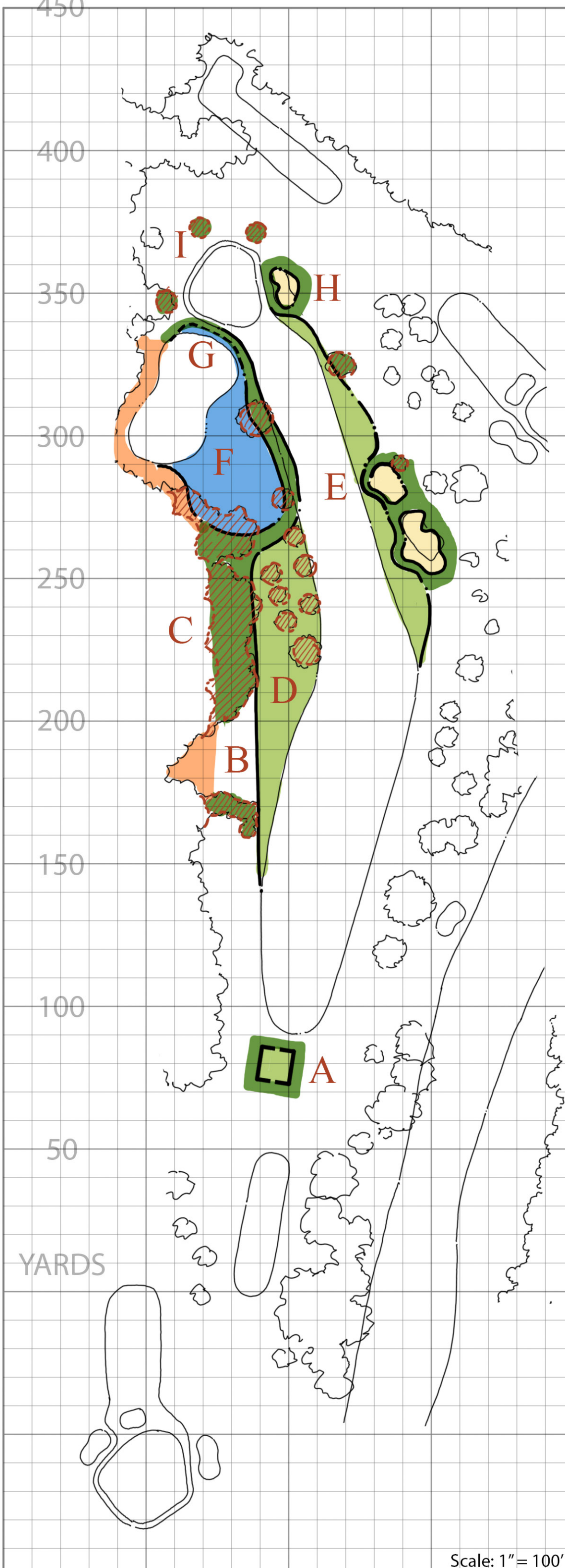

MASTER PLAN NOTES

Hole 14 Oswego Country Club

Par 5

Yardage: 483 - 476 - 401 - 401

520 483 435

Hole 14 –

- A. New back tee (?)
- B. New Senior tee
- C. Remove trees left side of hole
- D. Alternate route to hole with bunkers right side (needs a closer look)
- E. Relocate cart path circulation to left side of green

Green Area Plan

Scale: 1" = 50' (30' Grid)

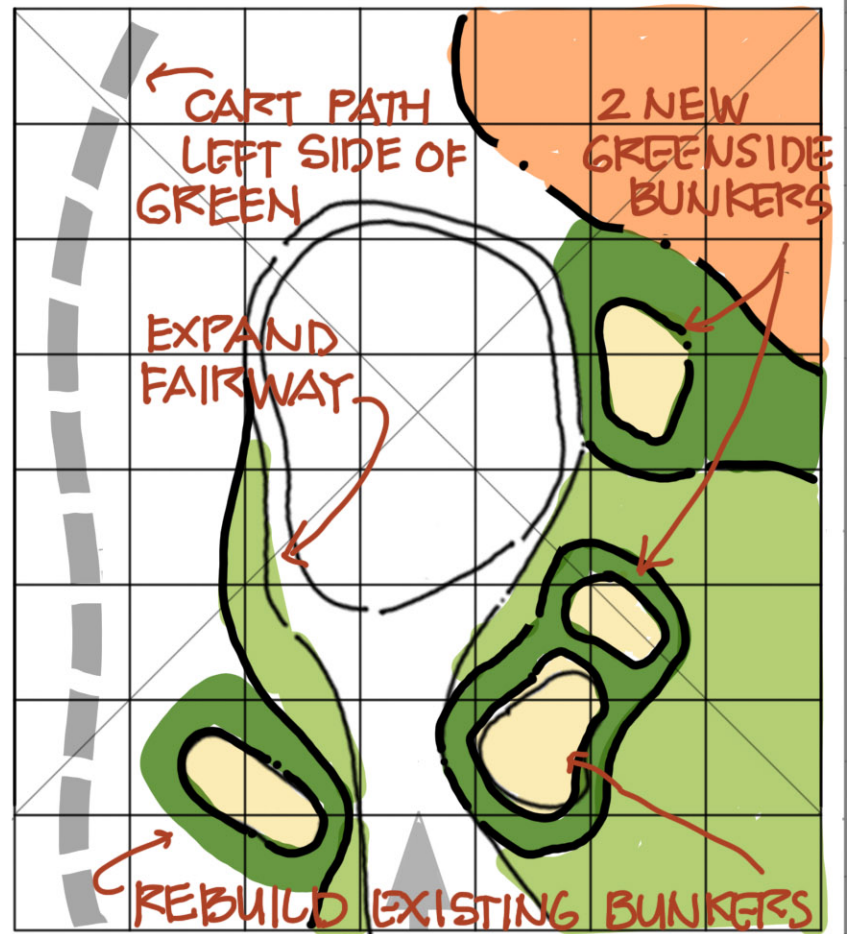

Centerline of Play

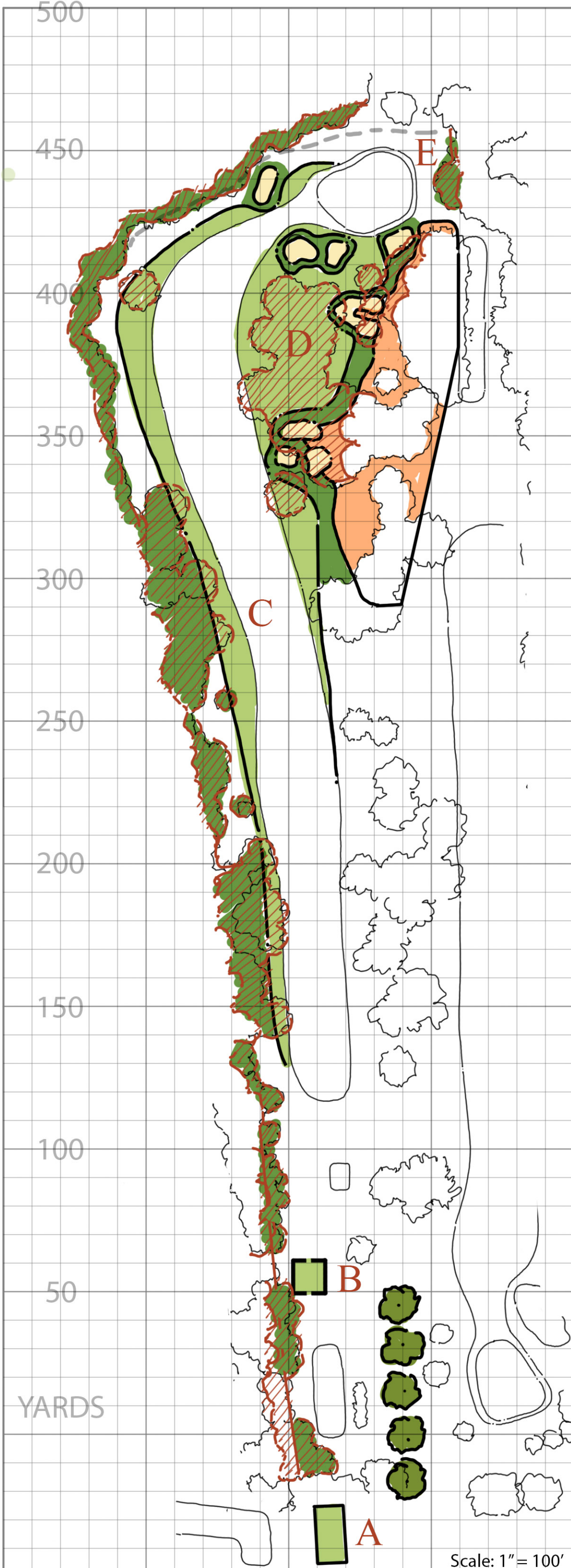

Scale: 1" = 100'

MASTER PLAN NOTES

Hole 15 Oswego Country Club

Par 4

Yardage: 334 - 327 - 242 - 242

267

Hole 15 –

- A. Add Senior tee
- B. Relocate front tee
- C. Remove trees as shown
- D. Expand fairway areas as shown
- E. Add fairway bunker on right side of hole (cut into natural landform)
- F. Rebuild existing bunkers
- G. Add run-off left front & right rear of green

Green Area Plan

Scale: 1" = 50' (30' Grid)

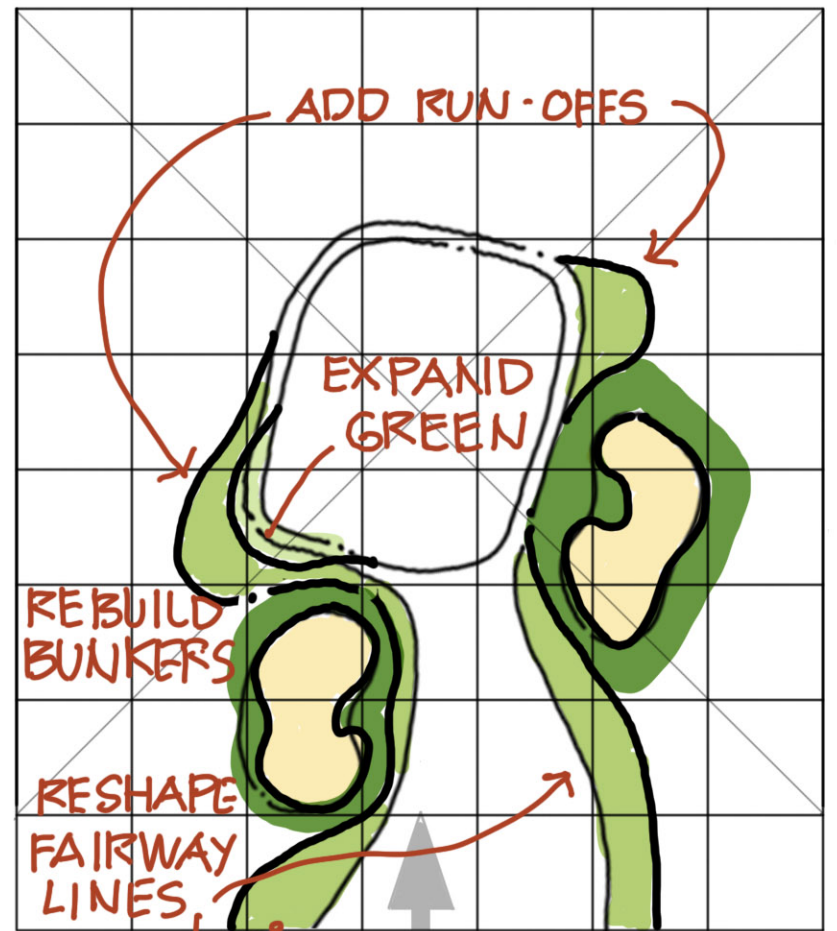

YARDS

50

100

150

200

250

300

350

400

450

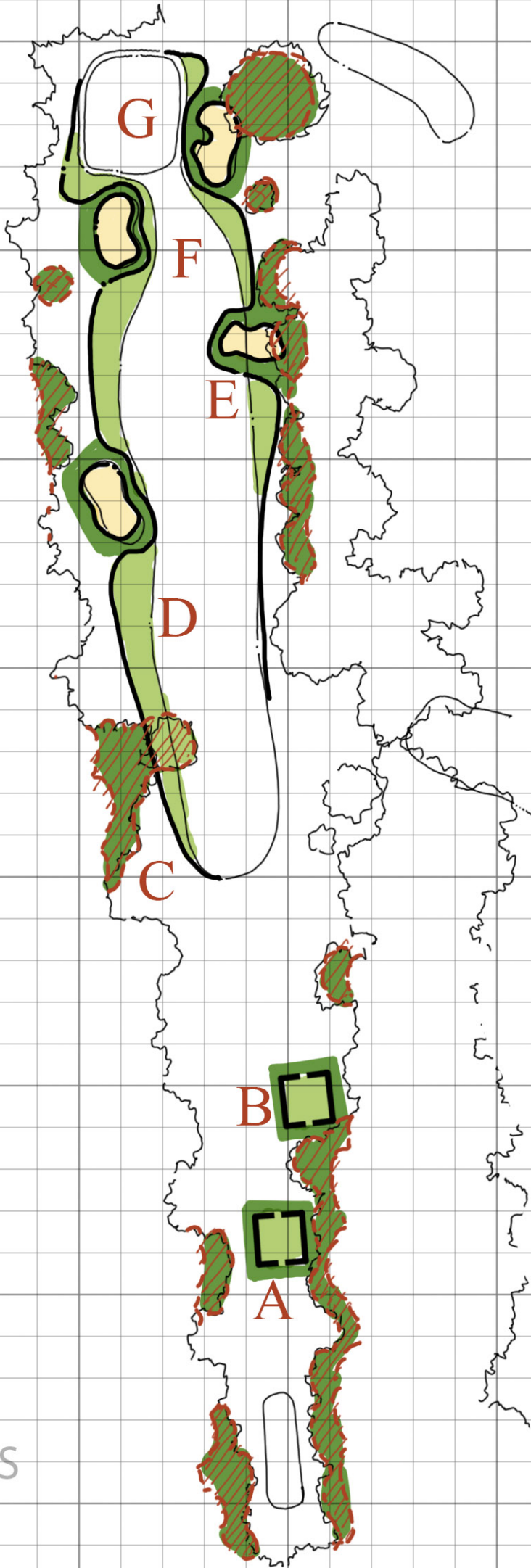

MASTER PLAN NOTES

Hole 16 Oswego Country Club

Par 4

Yardage: 337 - 327 - 314 - 314

265

Hole 16 –

- A. New forward tee (use occasionally for back tees to make “drivable” par 4)
- B. Elevate pond water level pond 12”– 18” to make more visible from tee (fill from behind pond)
- C. Remove trees as shown
- D. Rebuild bunkers
- E. Expand fairway as shown
- F. Cart path flow to right of green (eliminate cart path on left)

Green Area Plan

Scale: 1" = 50' (30' Grid)

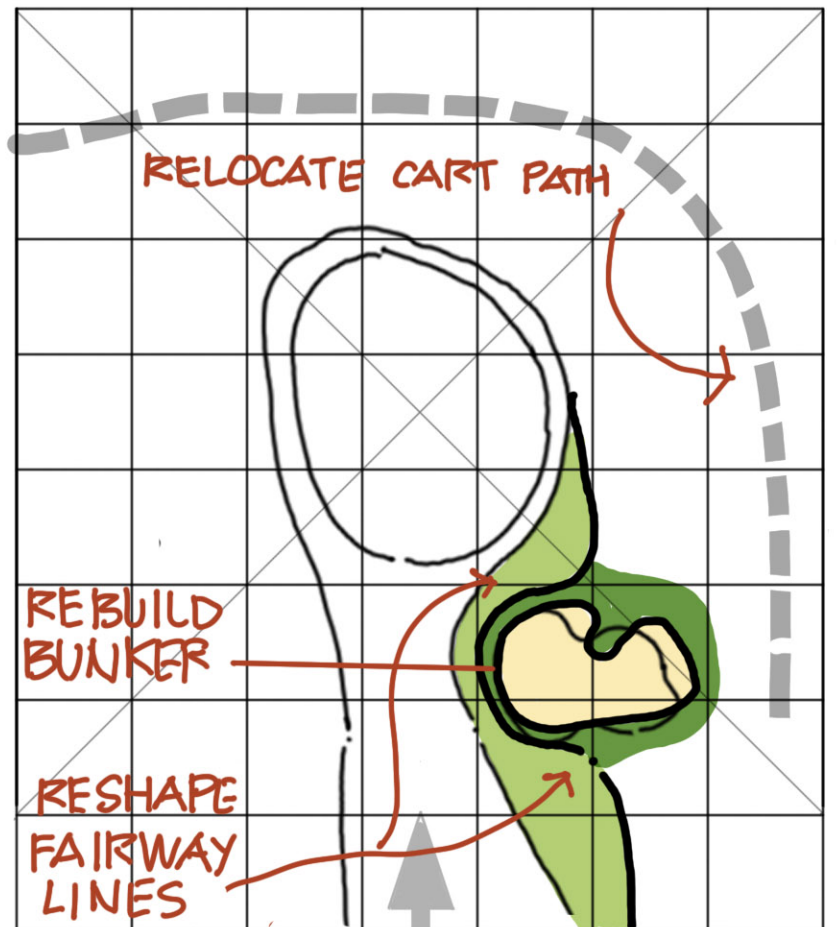

Centerline of Play

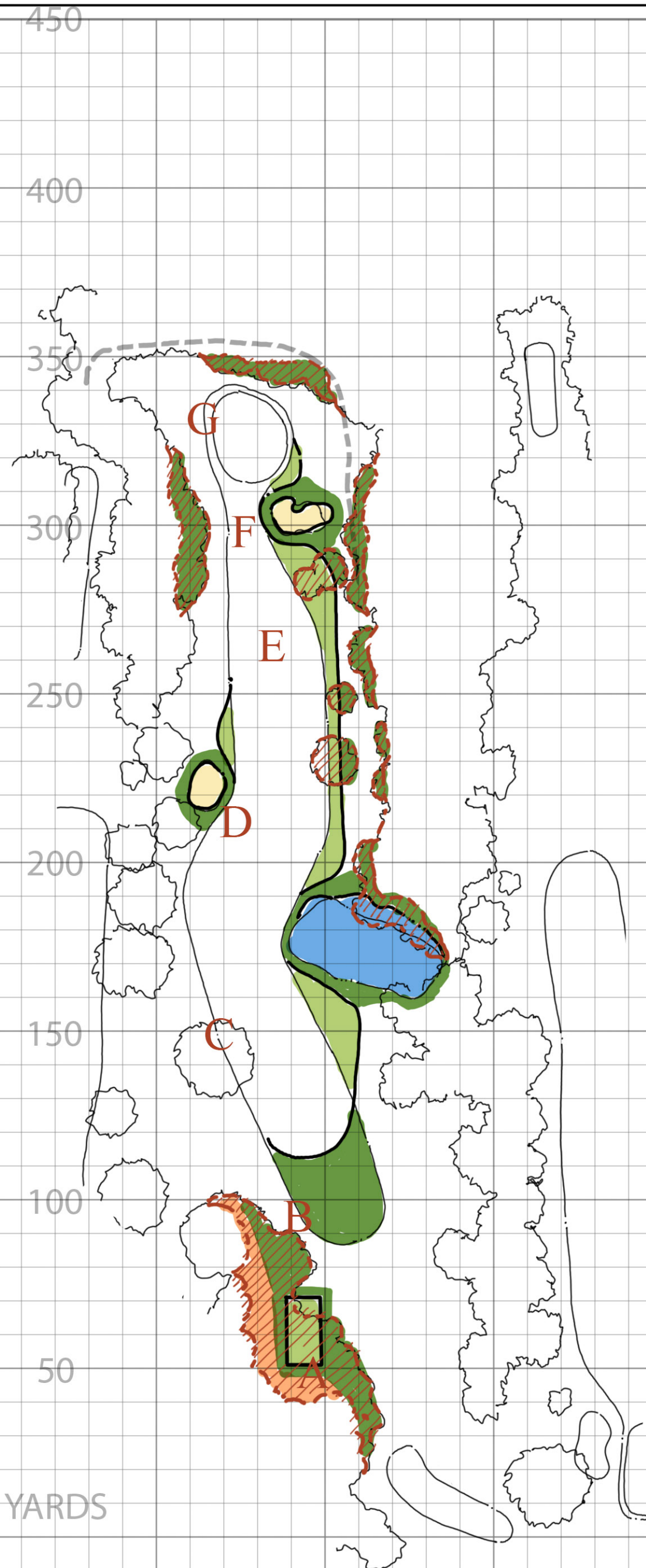

YARDS

Scale: 1" = 100'

MASTER PLAN NOTES

Hole 17 Oswego Country Club

Par 4

Yardage: 407 - 395 - 367 - 367

435 405 350 315

Hole 17 –

- A. Add back tee
- B. Break middle tee into 2 separate tees
- C. Add forward tee
- D. Rebuild fairway bunker on left side of fairway
- E. Add 2 fairway bunkers into landforms on right side of fairway
- F. Expand fairway as shown
- G. Remove trees as shown
- H. Rebuild existing greenside bunker
- I. Expand short grass areas around green as shown

Green Area Plan

Scale: 1" = 50' (30' Grid)

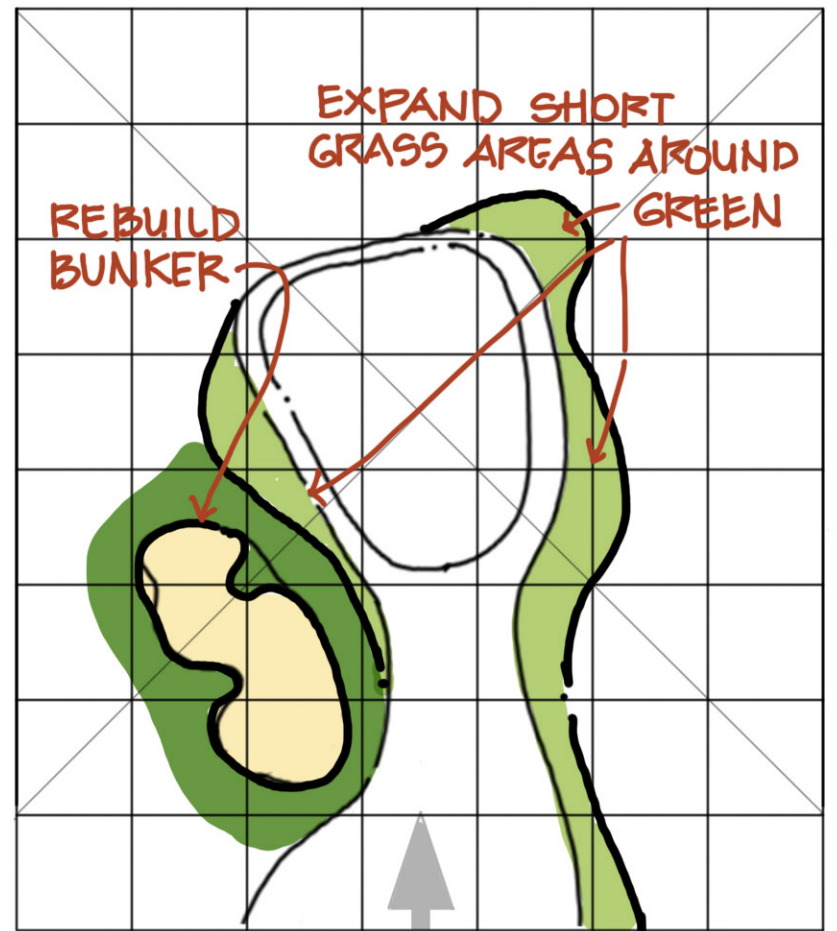

Centerline of Play

MASTER PLAN NOTES

Hole 18 Oswego Country Club

Par 3

Yardage: 177 - 150 - 135 - 122

195 170

Hole 18 –

- A. Add back tee (?)
- B. Remove trees as shown
- C. Expand fairway as shown
- D. Expand front of green
- E. Remove front bunker
- F. Reshape greenside bunkers as shown

Green Area Plan

Scale: 1" = 50' (30' Grid)

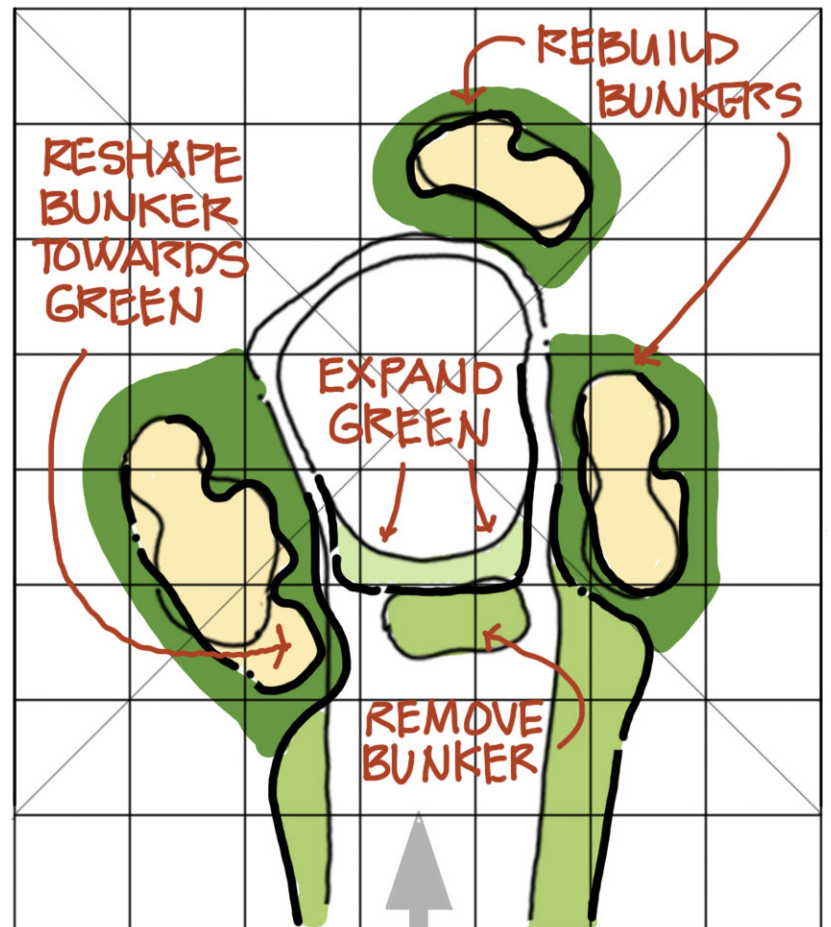

Centerline of Play

YARDS

Scale: 1" = 100'